

### Centering Guide for Meyer R11 - CG-101-M-W

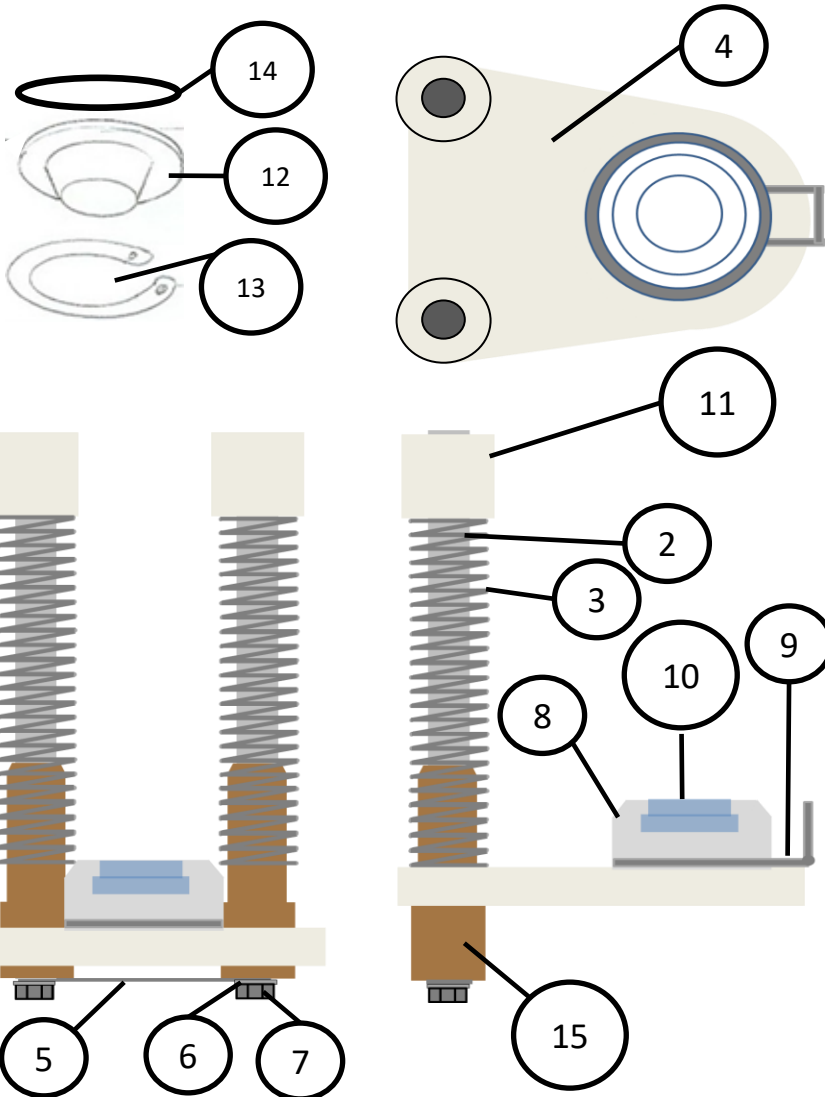

COMPANY: Enter Company Name

CONTACT: Point Contact for Account

#### BILL OF MATERIAL

ITEM	REQ'D	PART NO.	DESCRIPTION
1	0	MP-101-MB2	Meyer Bowl Mounting Plate Long
2	2	P-101-L	Long Post 7-7/16"
3	2	S-101-ST-7	Spring 7"LONG 0.052" STD
4	1	PL-101-L-1-1/2	Long, Large C'Bore (1-1.2" Shoulder Bushing)
5	1	RP-101-L	Retainer Plate Long
6	2	1/4" LW 18-8	Lockwasher
7	2	HEX HD 5/8	Bolt
8	1	CB-101-28-M	Centering Bell 28mm Meyer
9	1	CLIP-101-5/8"	SS Clip 5/8" Long Tang
10	1	SR-15-A-76	Seal 28mm 76 Duro White
			<i>Suggested Aluminum or Glass</i>
11	2	CUP-101-	Spring Cup
12	1	CONE-101-M-TRI	Meyer Cone
13	1	RR-101-1.5	Retainer Ring 1.5
14	1	OR-101-316	O'Ring for Meyer Cone
15		B-101-WS-1-1/2	Bushing w/ 1-1/2" Shoulder (Meyer)
			<i>Included in Plate Assembly for reference only</i>
			Subtotal
			Discount

This drawing is the property of Marks Machinery, Suwanee, GA. It is confidential and must not be copied, divulged, or submitted to others and is subject to return on demand.



Meyer R11 TriStar Wide Centering Guide

Drg. By / Date

K.Wheeler /03/12/21